

TABLEAU DE CHOIX DES CONSOLES

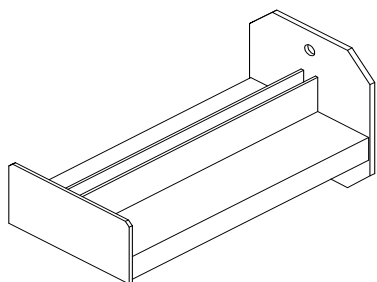

S 38

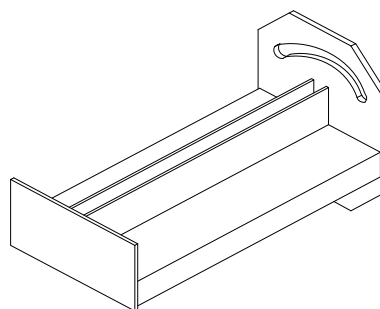

S 39-A

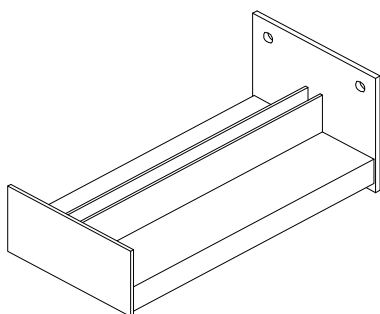

S 39-D

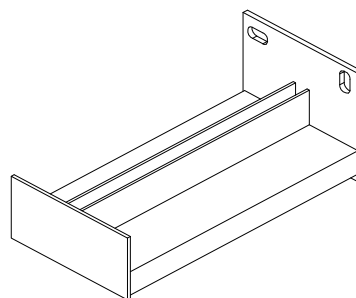

S 39-DS



Consoles pour tablettes béton

MATIERE : galvanisé à chaud

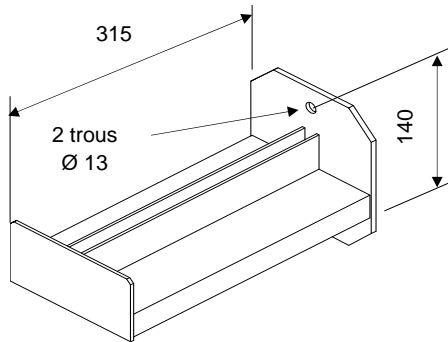

Console S 38
(code 095600)
Poids : 4,10 kg

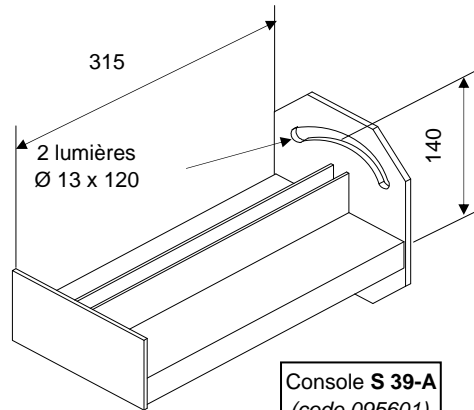

Console S 39-A
(code 095601)
Poids : 4,10 kg

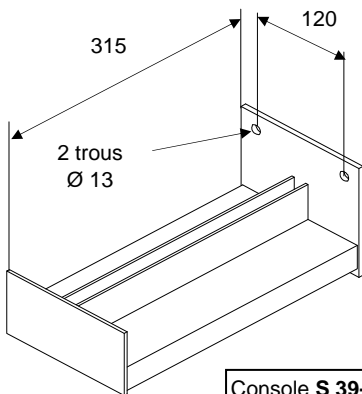

Console S 39-D
(code 095602)
Poids : 4,10 kg

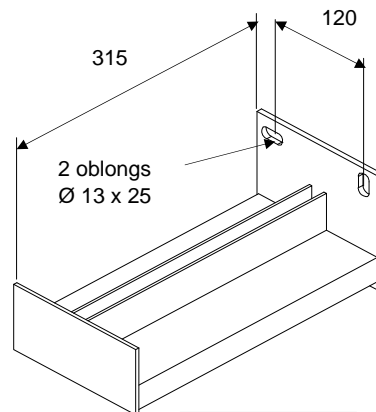

Console S 39-DS
(code 095603)
Poids : 4,10 kg

Toutes autres consoles,
tablettes métalliques
et fabrications spéciales
sur demande



Console S 38

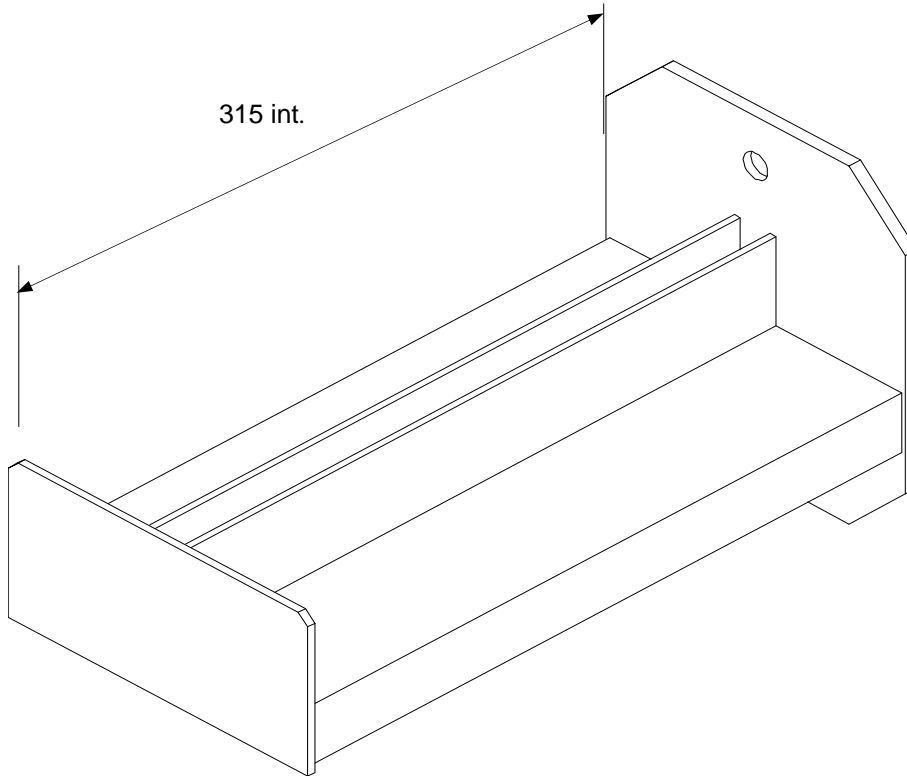

Matère : galvanisé à chaud
Poids : 4,10 kg
Code : 095600

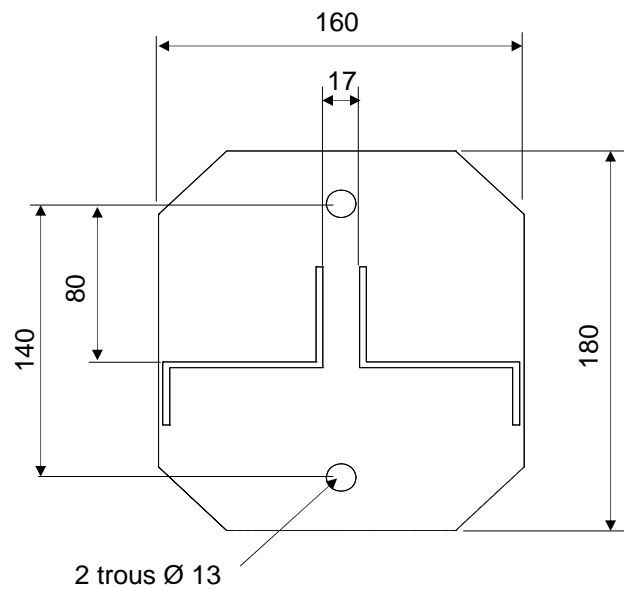

Console S 39-A

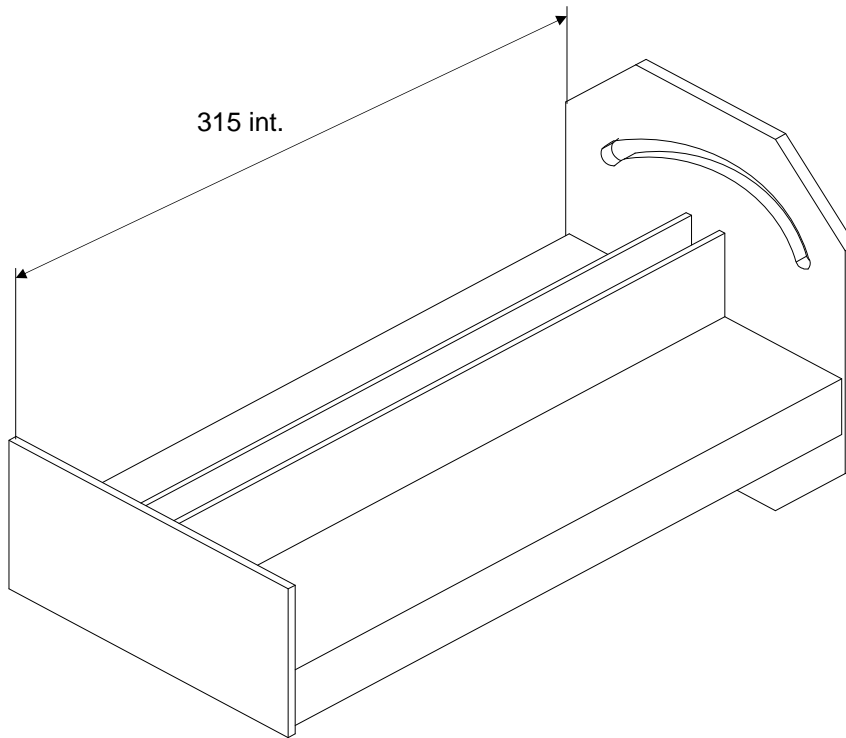

Matère : galvanisé à chaud
Poids : 4,10 kg
Code : 095601

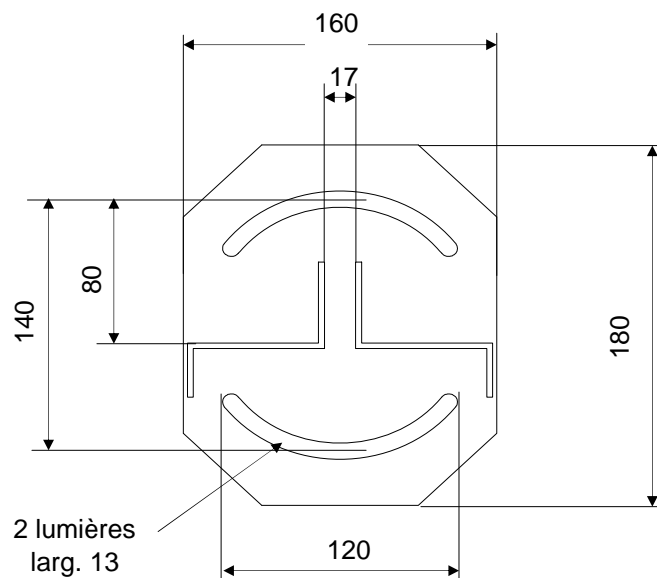

Console S 39-D

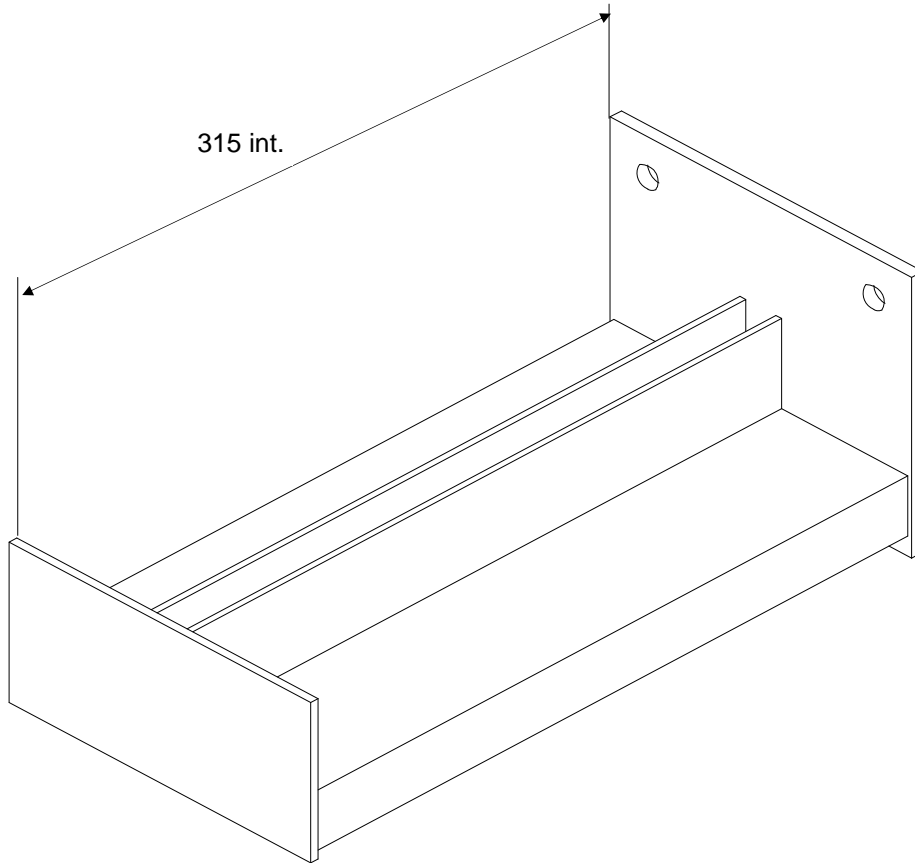

Matère : galvanisé à chaud
Poids : 4,10 kg
Code : 095602

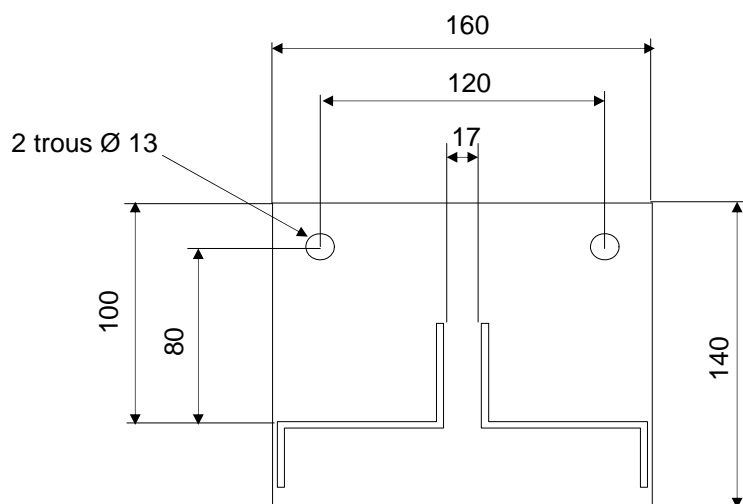

Console S 39-DS

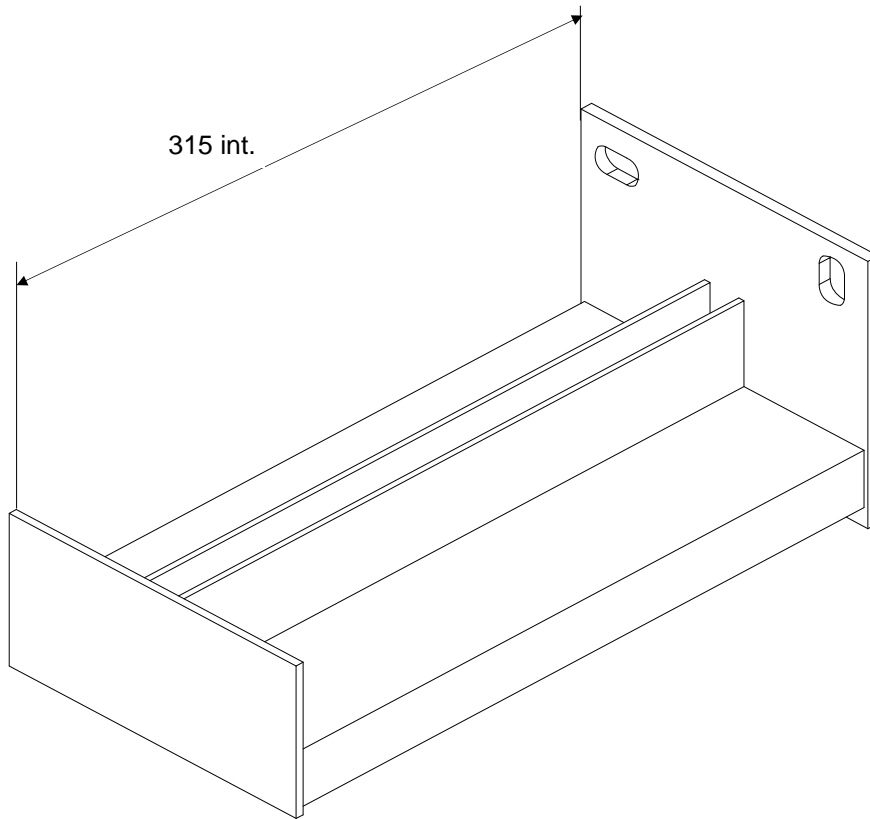

Matère : galvanisé à chaud
Poids : 4,10 kg
Code : 095603

