

# TABLEAU DE CHOIX DES SUSPENTES

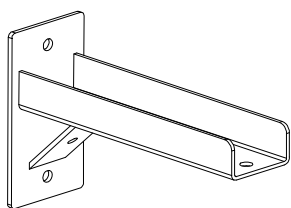

**US 80**

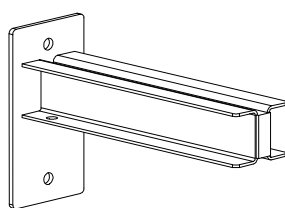

**US-E 80**

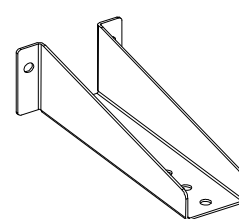

**US-L 80**

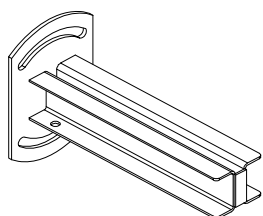

**US-O 80**

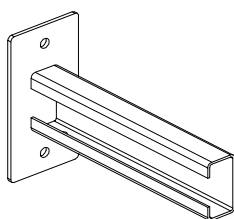

**US-R 80**

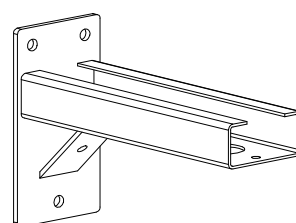

**US-V 80**

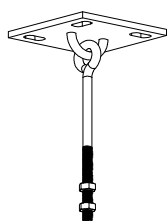

**S 42**

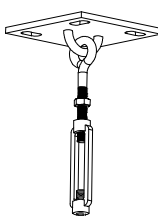

**S 49**

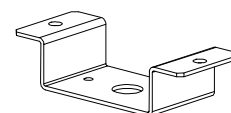

**S 49-V**

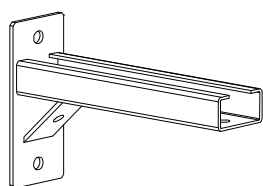

**US 60**

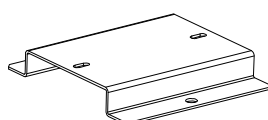

**Support  
au sol**

## Console US 80

Longueur 300	Code 095550	Poids 2,5 Kg
Longueur 400	Code 095551	Poids 3,1 Kg

MATIERE : galvanisé à chaud

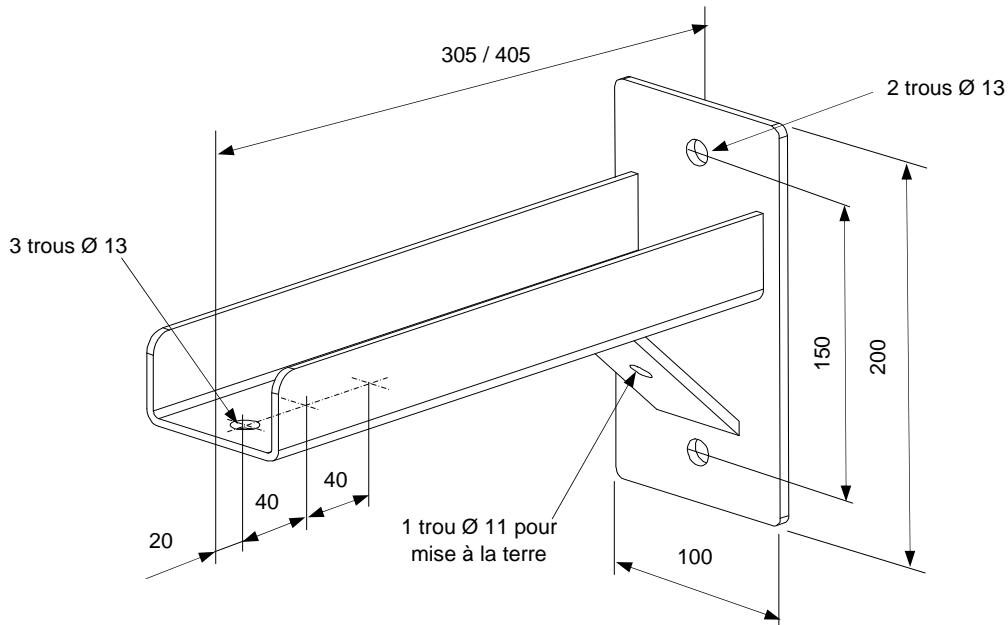

Charge admissible et réaction aux appuis

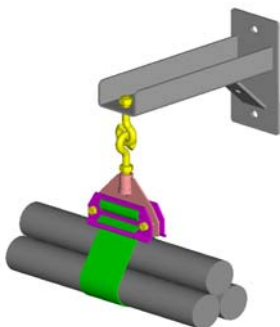
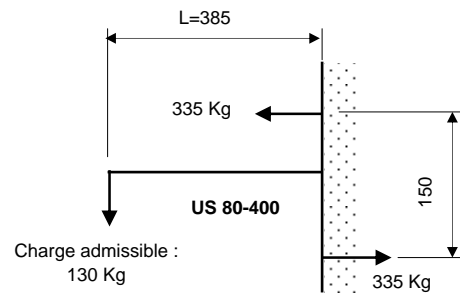
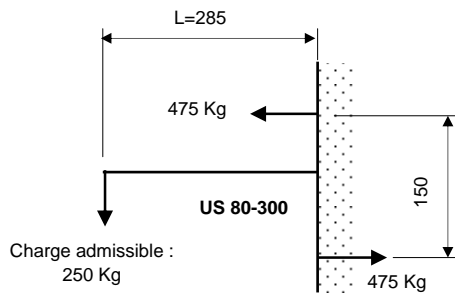

Exemple de montage  
avec anneau SAD 80  
support FBN 80  
grilles 12-80 et  
sangle 2-80

Exemple de montage  
avec étrier U 80  
support FBA 80  
grilles 12-80 et  
sangle 2-80

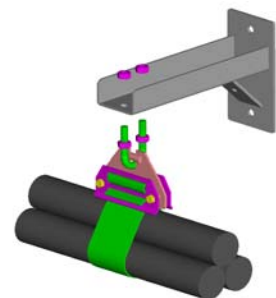

## Console US-E 80

Longueur 300	Code 095552	Poids 2,7 Kg
Longueur 400	Code 095553	Poids 3,6 Kg

MATIERE : galvanisé à chaud

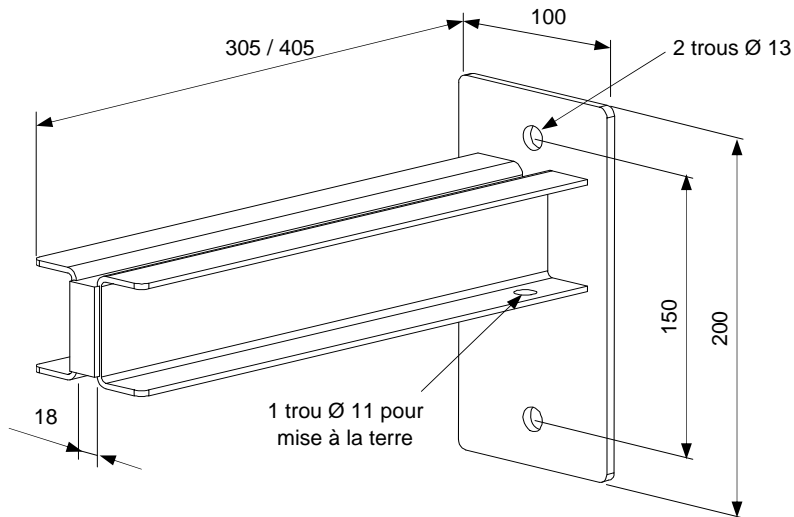

Charge admissible et réaction aux appuis

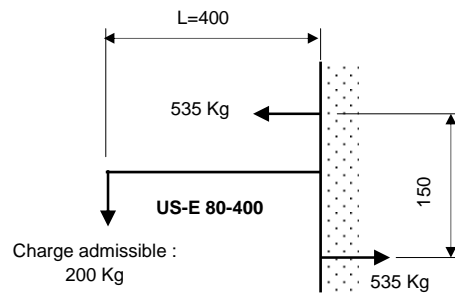
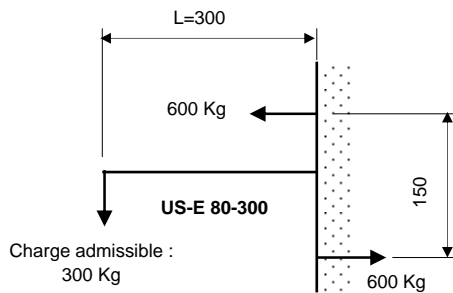

Exemple de montage avec FBN 80 complet plaque de serrage tige filetée et écrou HM 12

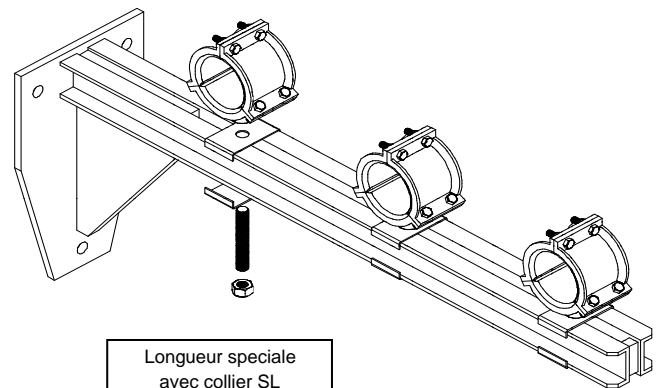
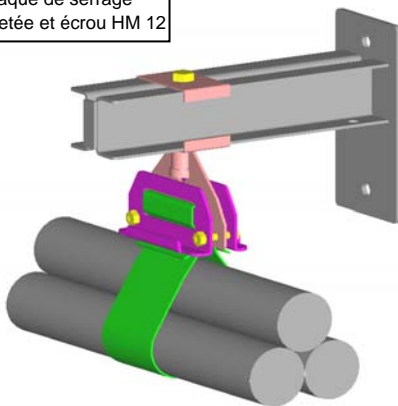

Longueur speciale avec collier SL plaque de serrage tige filetée et écrou HM 16

## Console US-L 80

Longueur 300	Code 095554	Poids 1,7 Kg
Longueur 400	Code 095555	Poids 2,1 Kg

MATIERE : galvanisé à chaud  
(Inox sur demande)

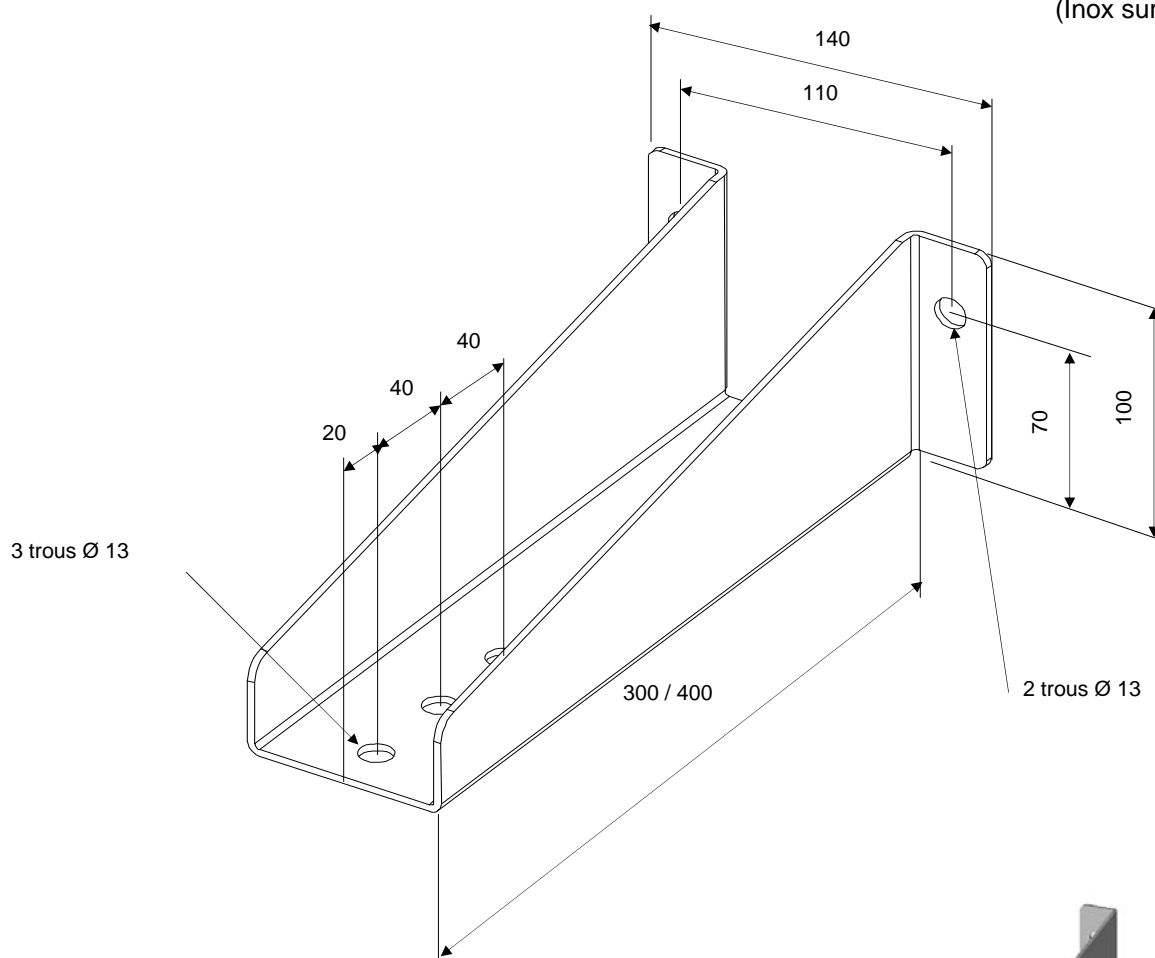

Exemple de montage  
avec support FBN 40  
anneau articulé SAD 40  
grilles 12-40 et sangle 2-40

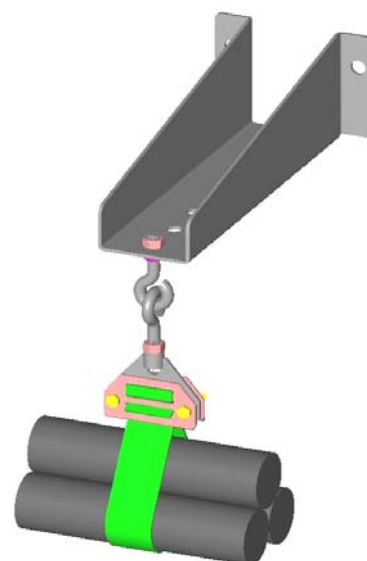

## Console US-O 80

Longueur 300	Code 095556	Poids 3,1 Kg
Longueur 400	Code 095557	Poids 3,6 Kg

MATIERE : galvanisé à chaud

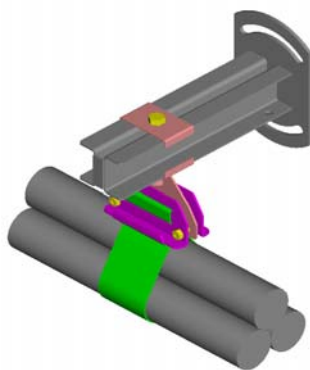
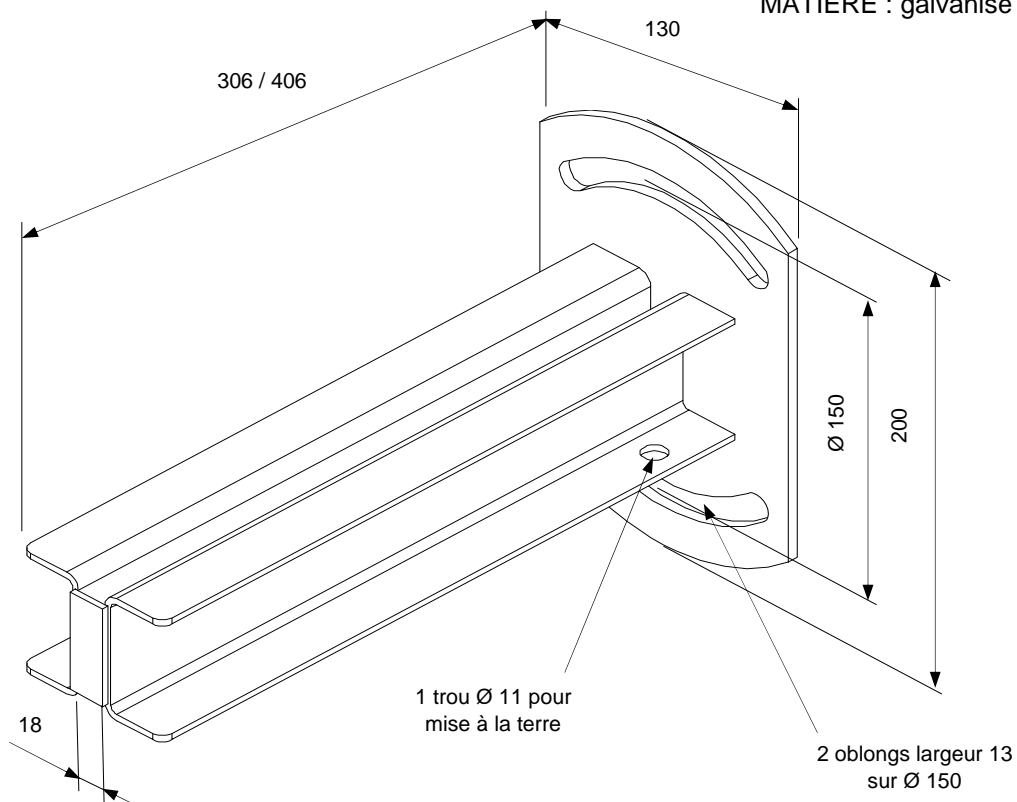

Exemple de montage  
avec poteau et  
colliers SL

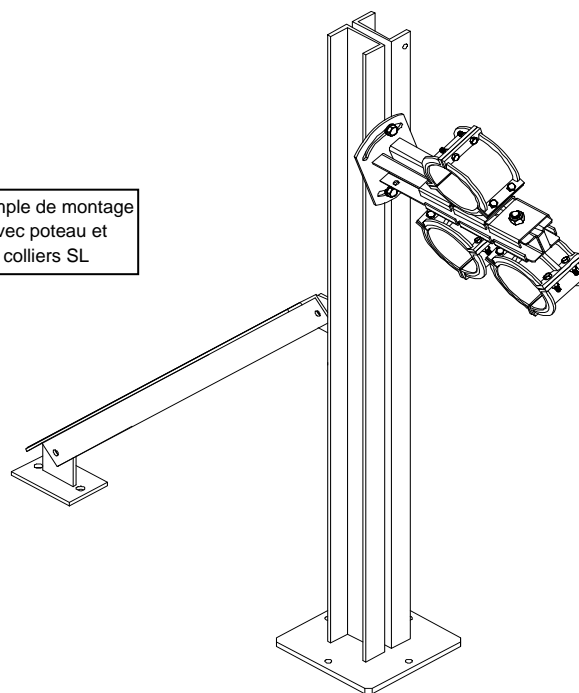

## Console US-R 80

Longueur 300	Code 095558	Poids 2,1 Kg
Longueur 400	Code 095559	Poids 2,6 Kg

MATIERE : galvanisé à chaud

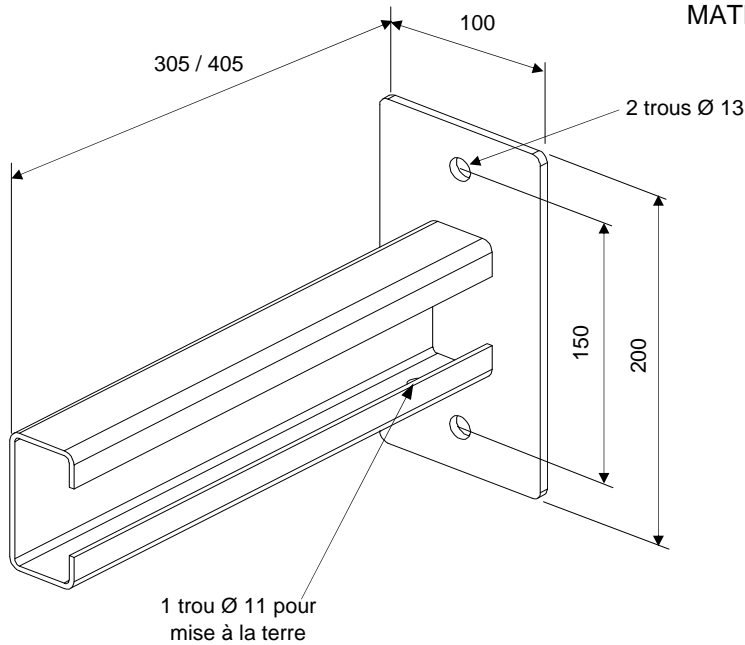

1 trou Ø 11 pour mise à la terre

Charge admissible et réaction aux appuis

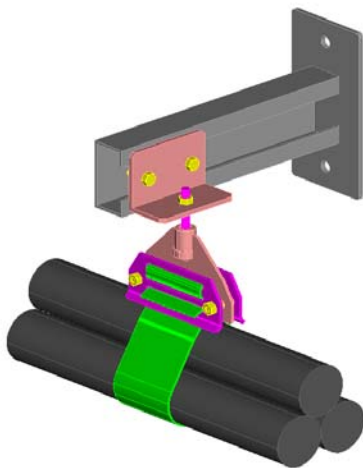
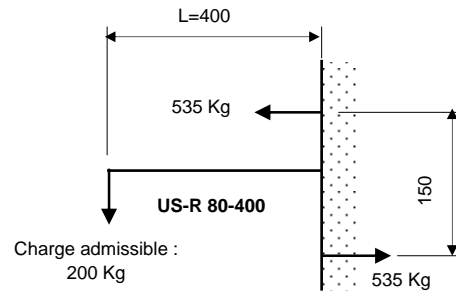
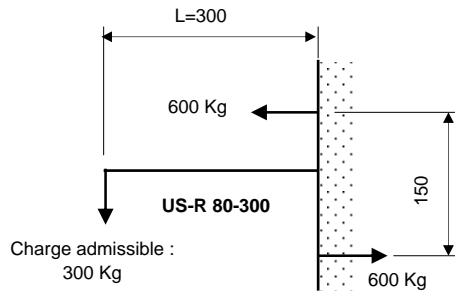

Exemple de montage avec équerre réglable support FBN 80 grilles 12-80 et sangle 2-80

## Console US-V 80

Longueur 300	Code 095560	Poids 2,9 Kg
Longueur 400	Code 095561	Poids 3,4 Kg

MATIERE : galvanisé à chaud

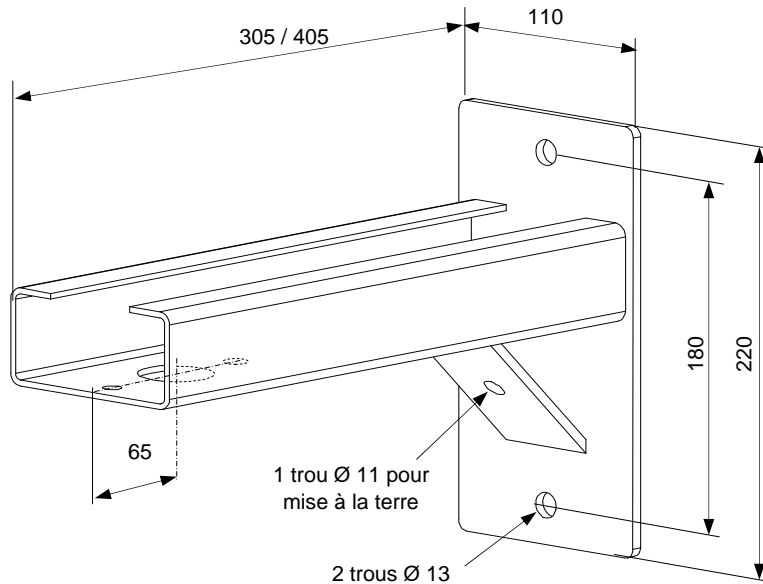

Charge admissible et réaction aux appuis

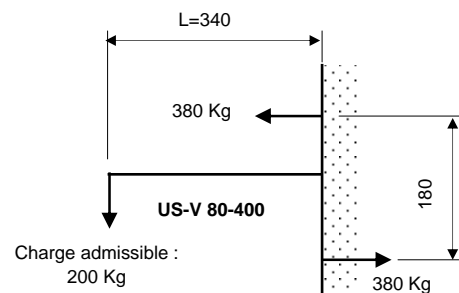
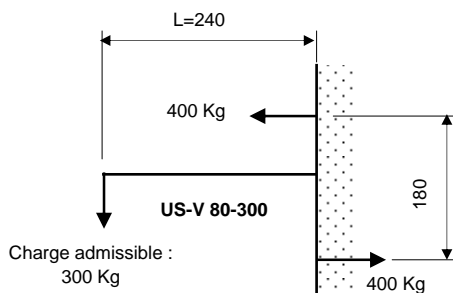

Plot anti-vibratoire  
charge nominale 80 daN  
ou 120 daN

Exemple de montage  
avec anneau SAD 80  
support FBN 80  
grilles 12-80 et  
sangle 2-80

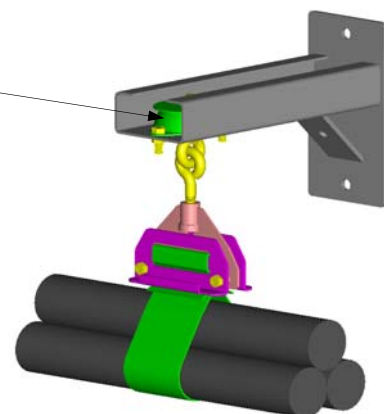

## Support type S 42

Matière : Platine galva à chaud  
 Tendeur M 12 (zingué blanc) (code 095570)  
 Tendeur M 10 (inox) (code 095570-i)

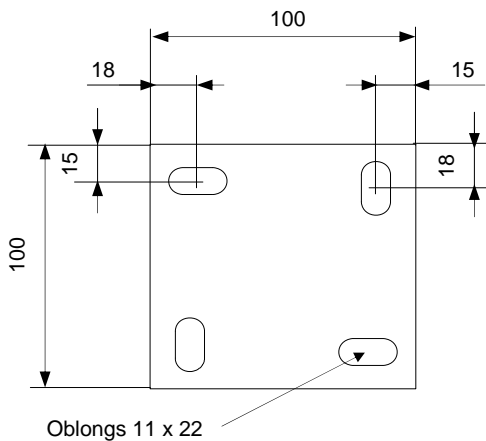
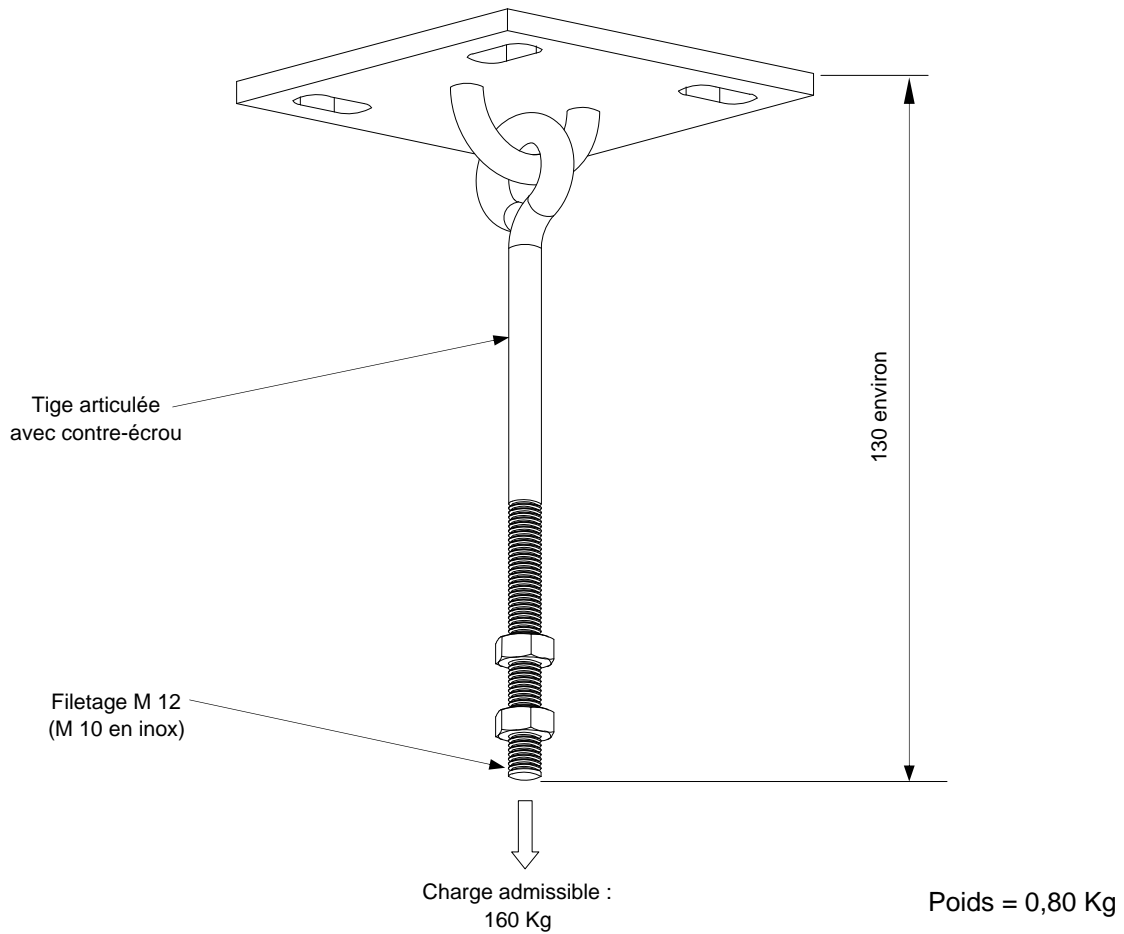

Exemple de montage avec FBN 80

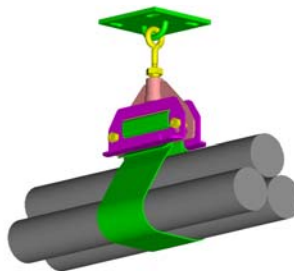

Exemple de montage avec grilles 1/80 et sangle 2/80

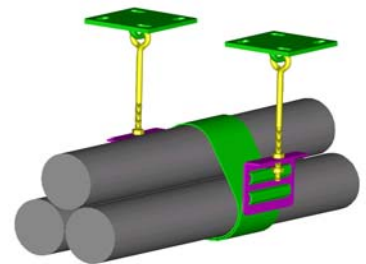

## Support type S 49

Matière : Platine galva à chaud  
 Tendeur M 12 (zingué blanc) (code 095571)  
 Tendeur M 10 (inox) (code 095571-i)

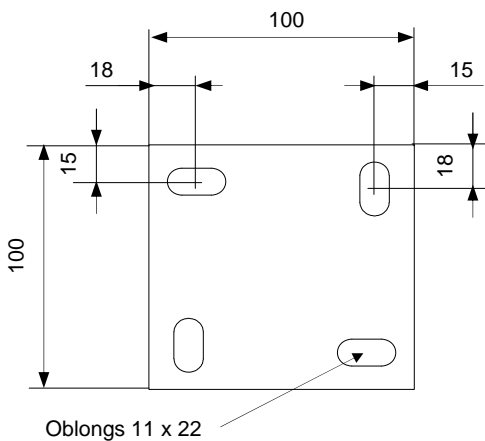
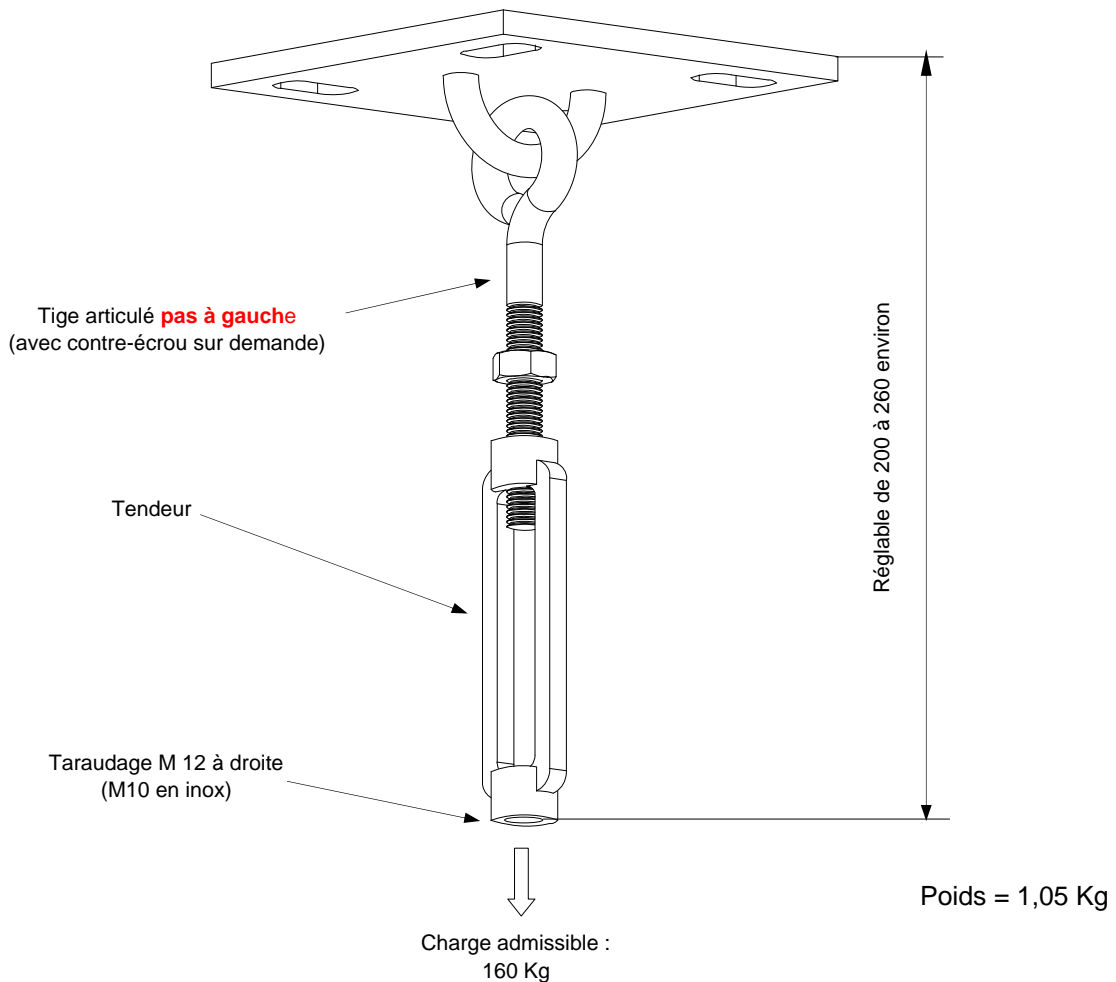

Exemple de montage  
 avec FBN 80

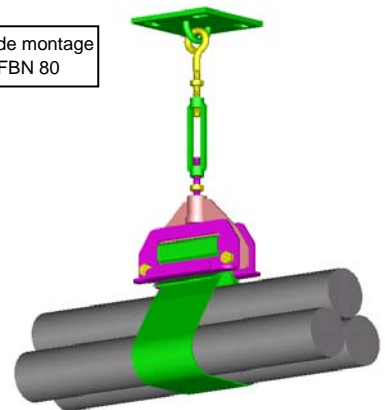

## Support antivibratoire type S 49-V

Matière : galva à chaud (code 095572)  
(inox sur demande)

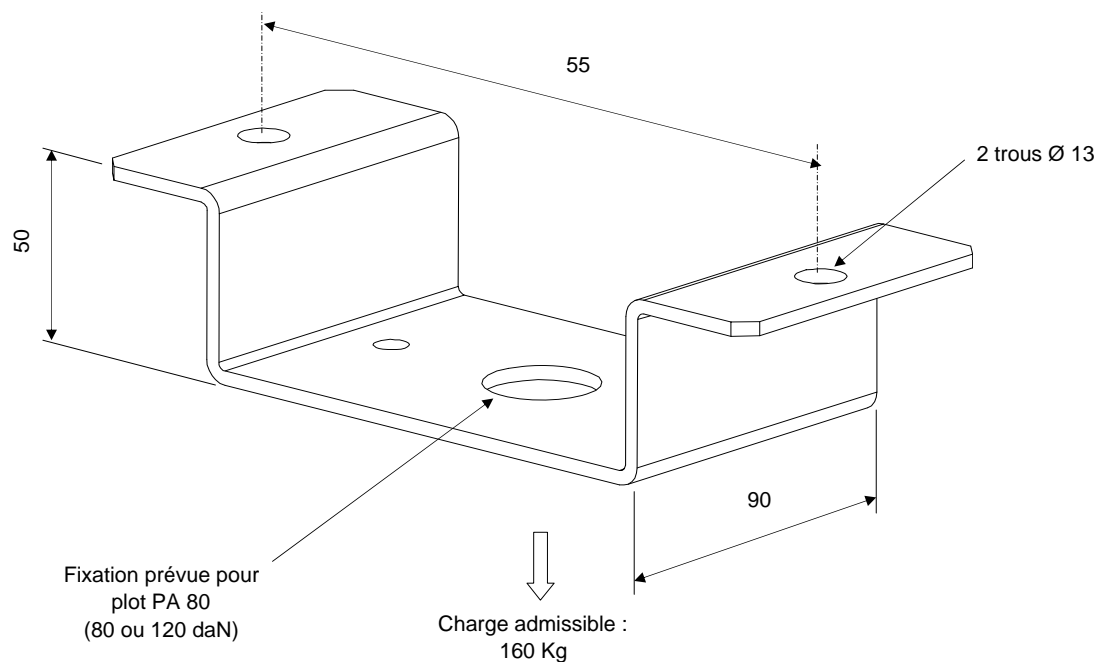

Poids = 1 Kg

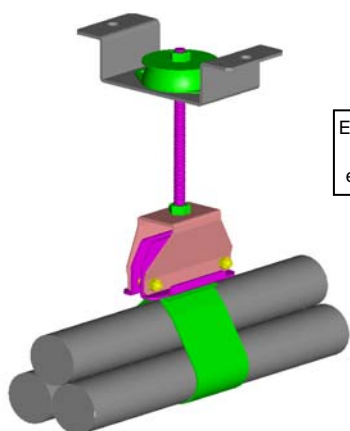

Exemple de montage  
avec S 80  
et plot antivibratoire

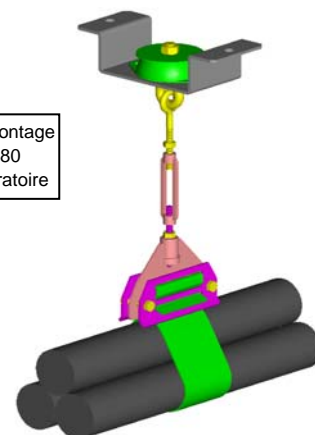

Exemple de montage  
avec FBN 80  
et plot antivibratoire

## Console US 60

Code : 095562 MATIERE : inox  
Poids : 1,3 kg

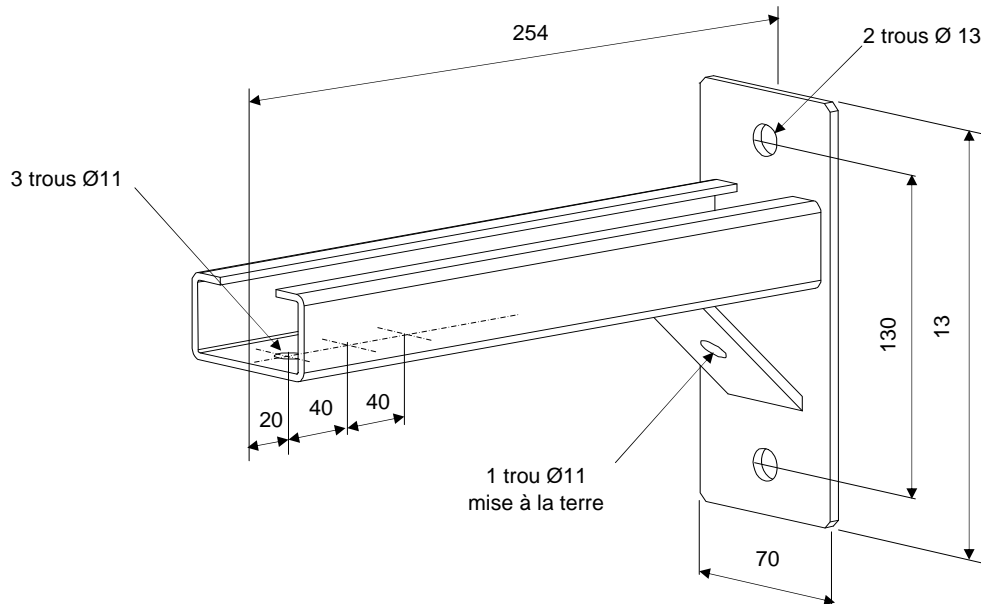

### Charge admissible et réaction aux appuis

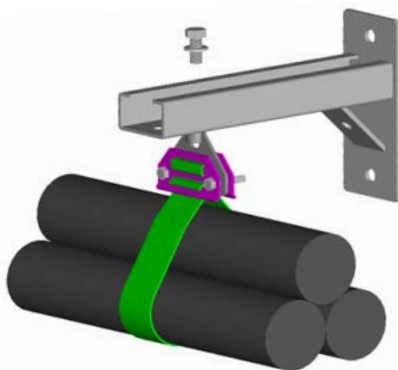
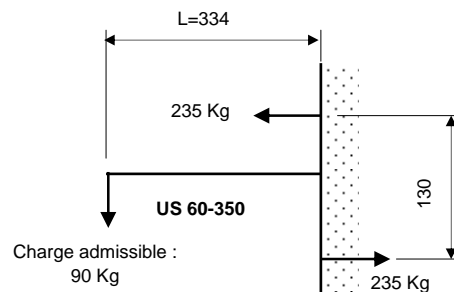
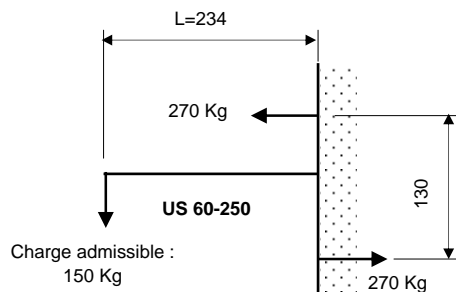

Console US 60  
avec FBN 40 et grilles 12/40

Console US 60  
avec FBA 40 avec anneau  
et grilles 12/40

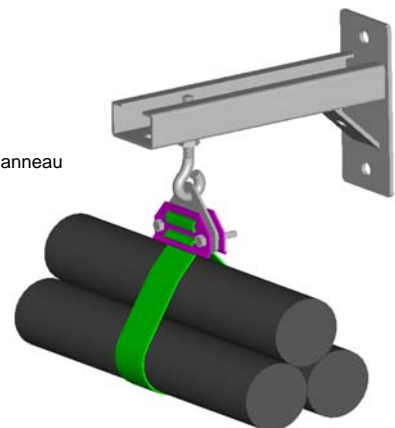

## Support au sol

Code : 095573  
MATIERE : inox  
Poids : 1,3 kG  
(en largeur 200)

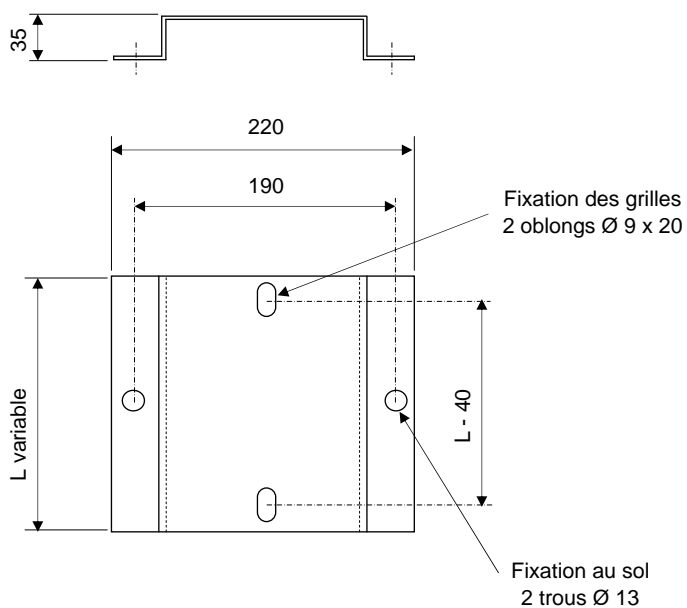
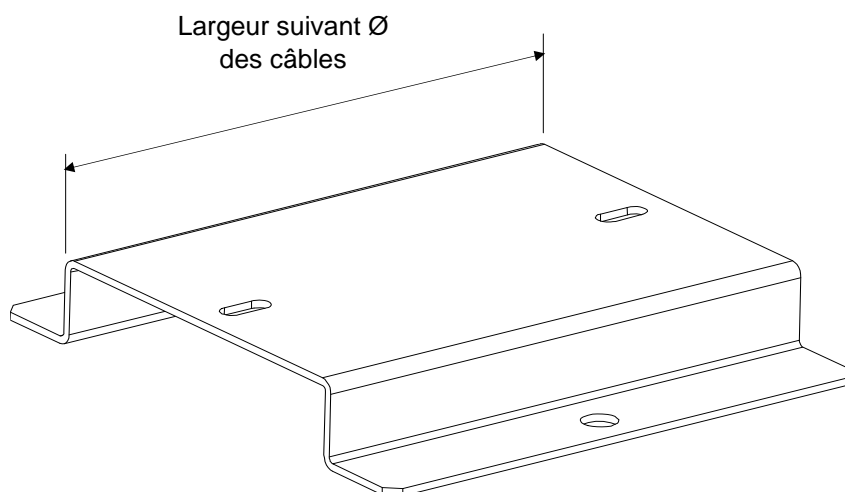

Support au sol  
avec grilles 1/40  
et Hypalon

